

CERTIFIED RECORD OF LAND CORNER MONUMENTATION

History of original corner establishment:

Set by Robb & Eckelson in 1880, under contract no. 366, dated August 18, 1880.

Surveyor General's records state:

40.0 chains, Set post with pits and mound per instructions

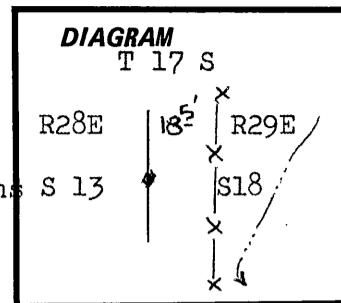

Description of corner evidence found:

No evidence of this corner found. Searched for on two separate occasions

Search area falls on west side of north/south fence line on steep southeast slope, just above a small draw running south west.

Description of monument and accessories I established to perpetuate the original location of this corner:

At the proportionate distance between found corners I set a standard F.S. aluminum monument consisting of a 3" disk mounted on a 2"x30" pipe with a 4x4 1/2" footplate, buried 18" in the ground. Disk is stamped as shown:

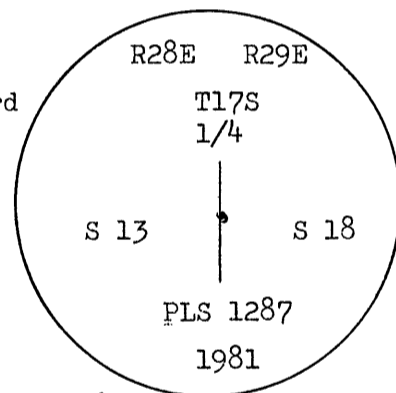

Corner lies 18.5 feet east of north/south fence line on steep SE slope, just above a draw running south east.

Monument set 10/26/81

Witnesses: H.W. Palmer
P. Zabala

Monument set as part of U.S. Forest Service "Three Piece" cadastral survey, see Survey Plat dated Nov. 1981, Grant County Survey No. 708.

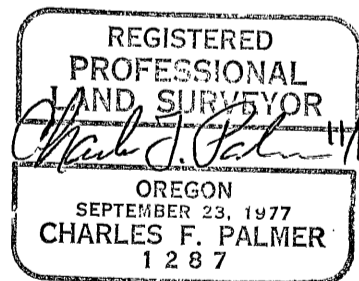

Office of.....Surveyor..... County of.....Grant.....
 State of.....Oregon....., I hereby certify that the within instrument was filed in this office
 for record on the.....18..... day of.....Dec....., 19.....81.....
 Robert D. Saggett by..... (COUNTY OFFICIAL) (DEPUTY)